

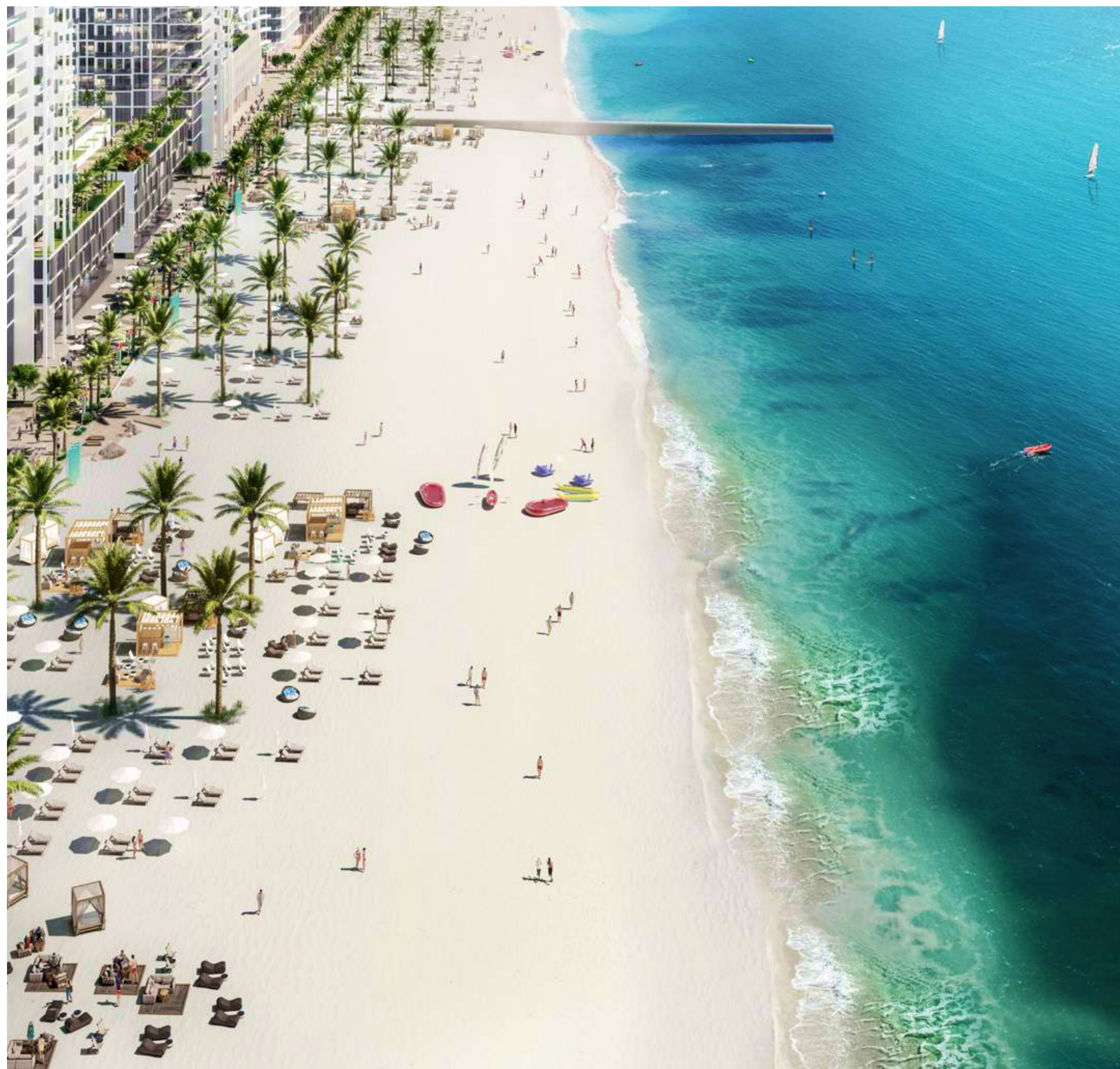

ADDRESS
RESIDENCES
THE BAY

EMAAR



EMAAR BEACHFRONT

Come home to Dubai's most exclusive island. Located within the new maritime centre of the UAE, Emaar Beachfront is a meticulously master-planned beachside haven – a unique blend of cosmopolitan living, prime location and a luxury urban lifestyle.



YOUR PREMIUM BEACH ADDRESS



1.5 KM of
Pristine Beach



Panoramic Views
of the Sea & Marina



Steps Away from
Marina & Yacht Club



Direct Access to
Sheikh Zayed Road



Community
Parks



Nearby Licensed
Restaurants

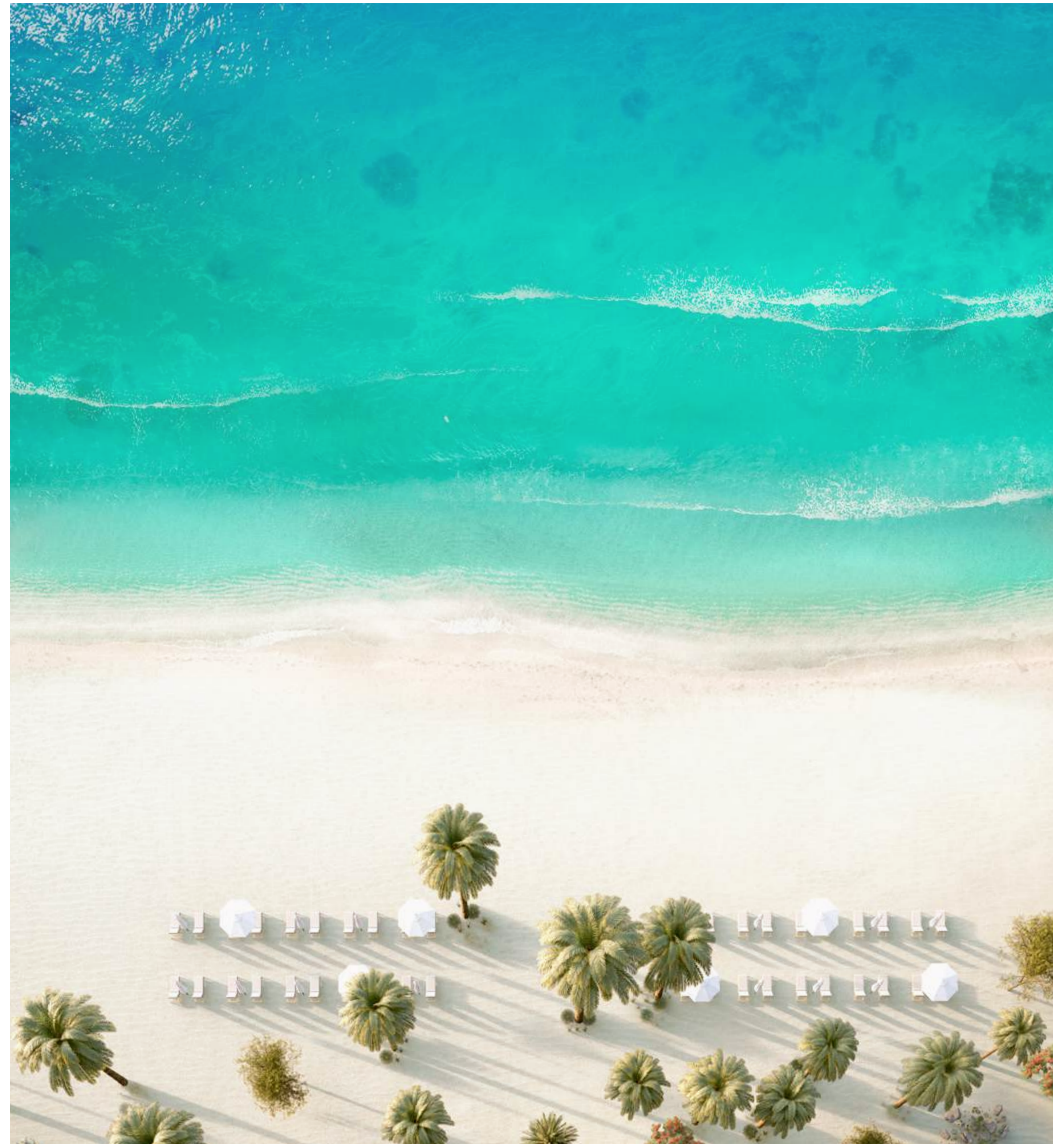

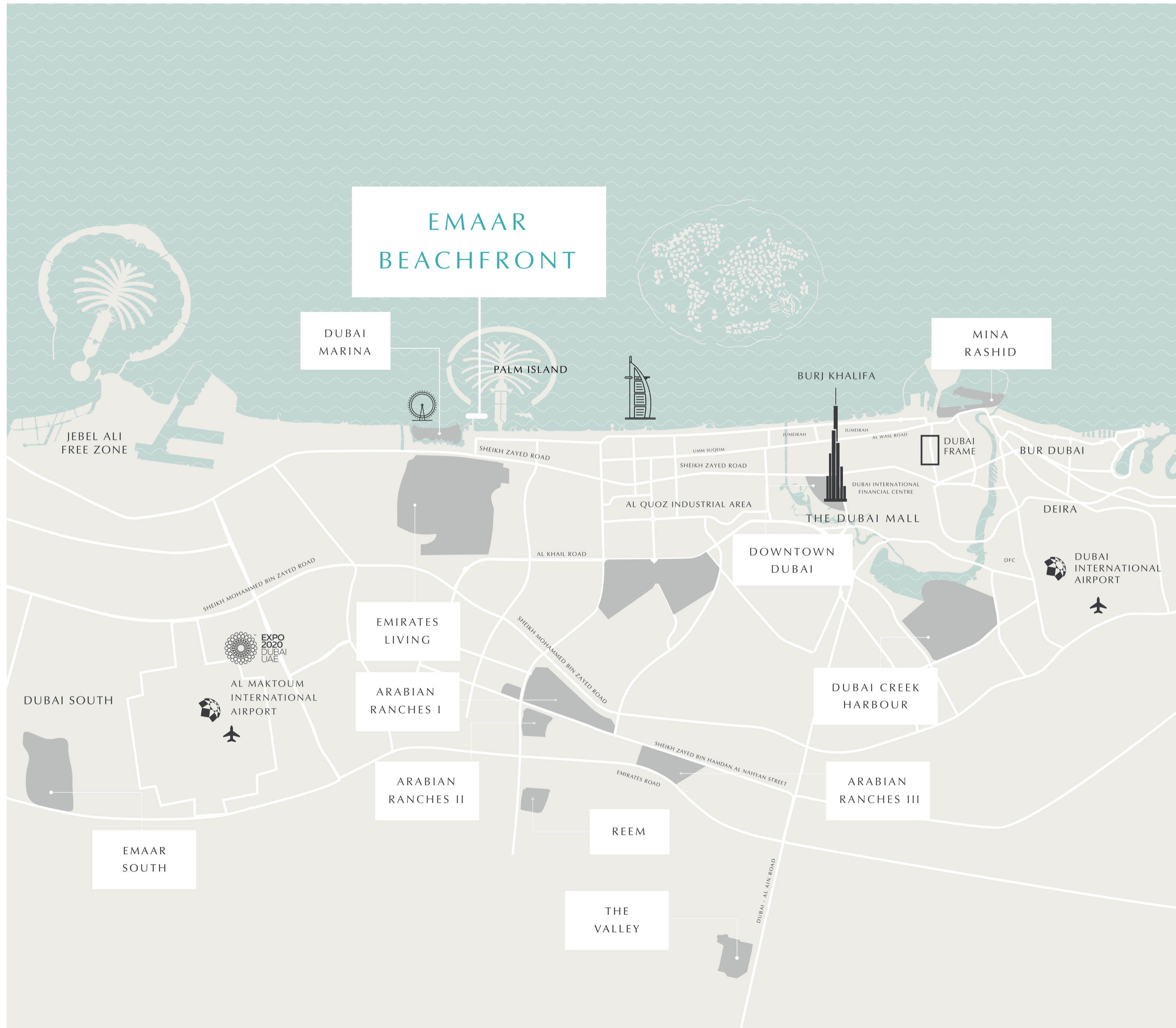

EMAAR
BEACHFRONT

AN EXCLUSIVE BEACHFRONT LOCATION

05 Mins to
Dubai Marina

05 Mins to
Sheikh Zayed Road

15 Mins to
Downtown Dubai

25 Mins to
Dubai Intl. Airport



YOUR DREAM
BEACHSIDE LIFESTYLE,
REALISED

ADDRESS RESIDENCES – THE BAY

THE EPITOME OF 5-STAR LIVING

Situated at the water's edge, along Emaar Beachfront's pristine sands, Address Residences – The Bay comprises branded apartments, penthouses and townhouses. Offering residents the ideal urban island lifestyle, Address Residences – The Bay will set new standards of luxury.



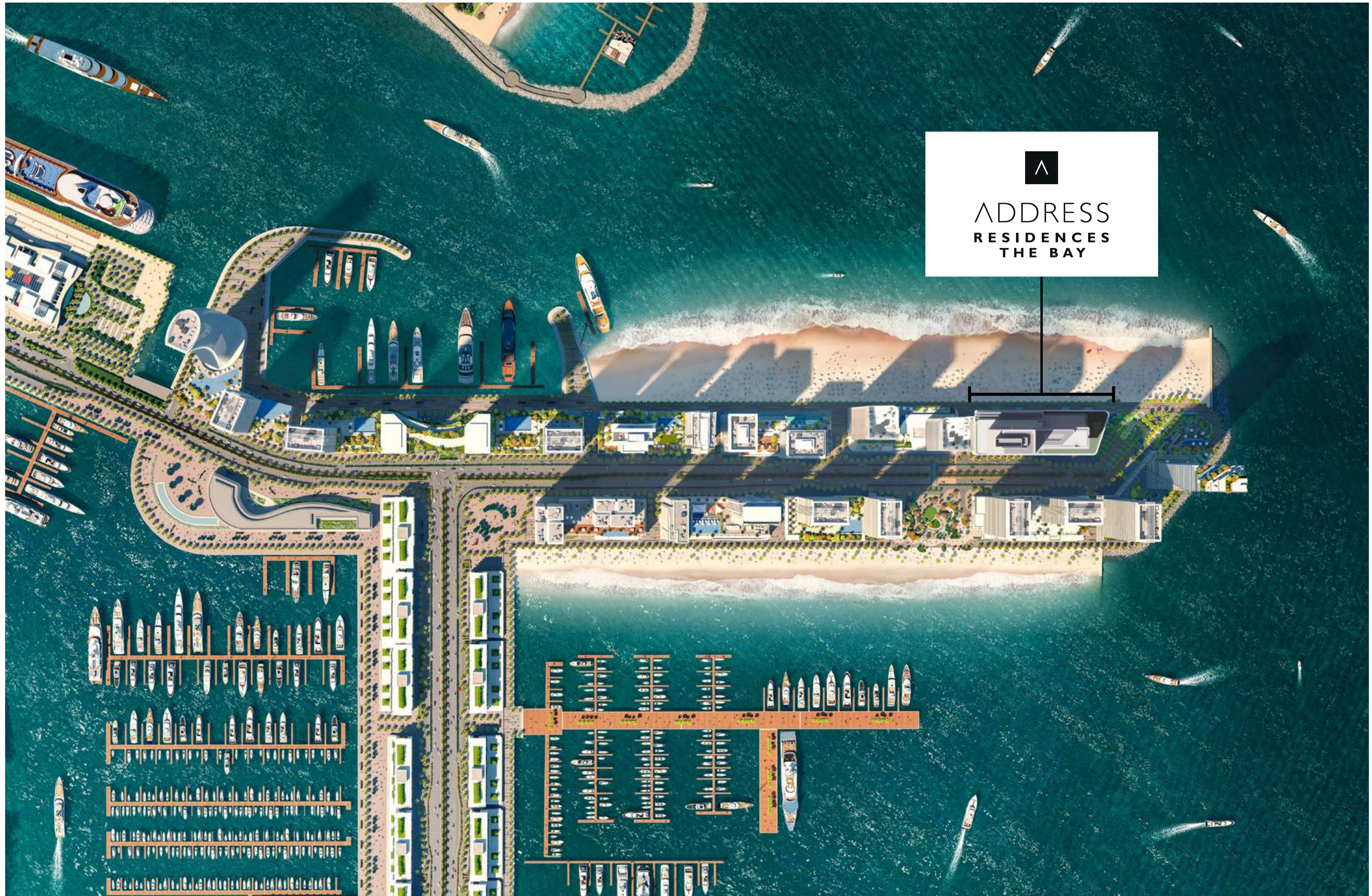

ADDRESS
RESIDENCES
THE BAY

SEA, SAND & SPECTACULAR VIEWS





YOUR IDEAL LIFESTYLE, REDEFINED

With world-class dining experiences and retail destinations just footsteps away, Address Residences – The Bay elevates your everyday living experience with truly exceptional amenities.



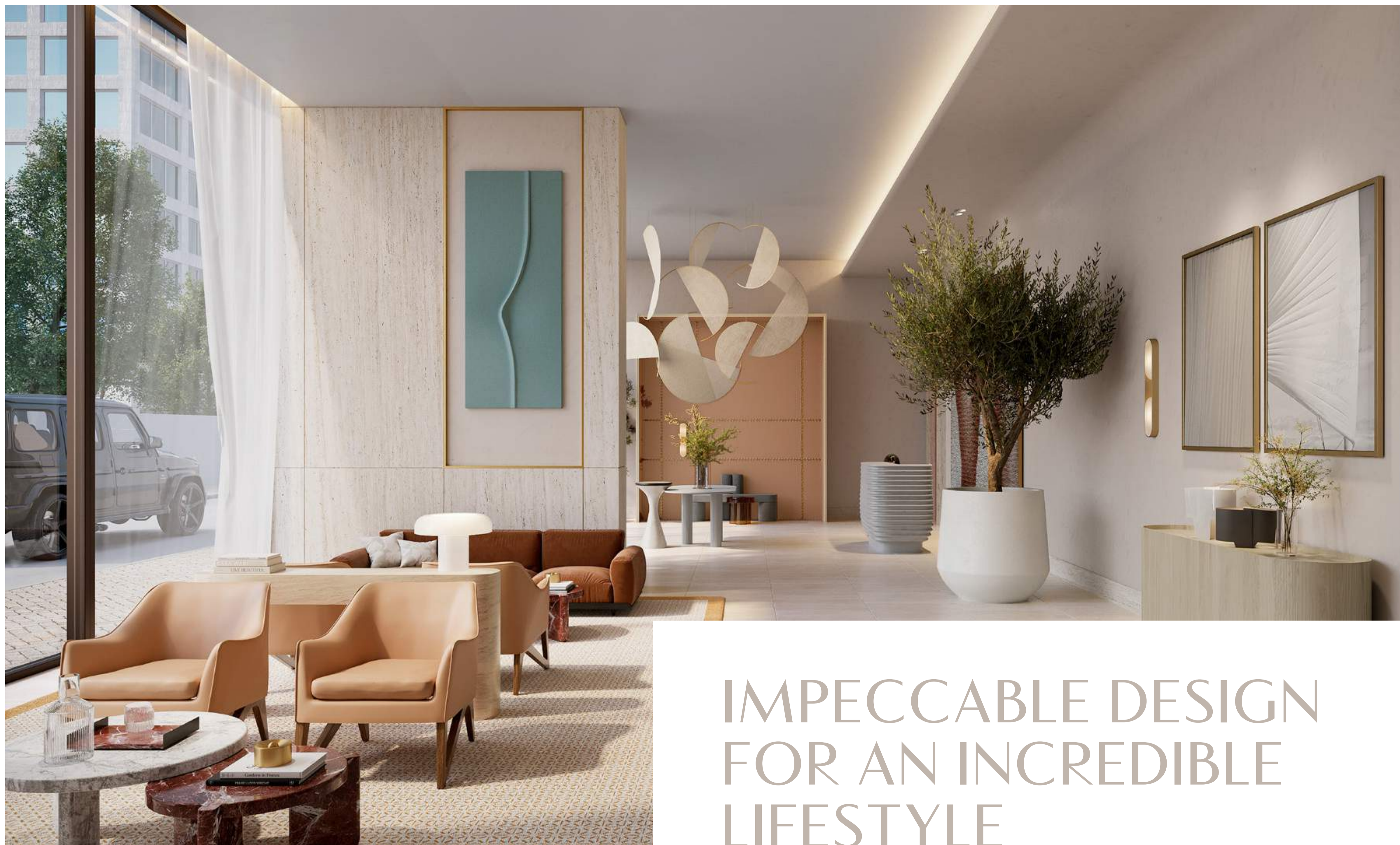

IMPECCABLE DESIGN
FOR AN INCREDIBLE
LIFESTYLE

A TOUCH OF CLASS IN EVERY DETAIL

Unbridled luxury, effortless elegance and impeccable design create an aesthetic that beautifully complements the idyllic beachfront setting outside.

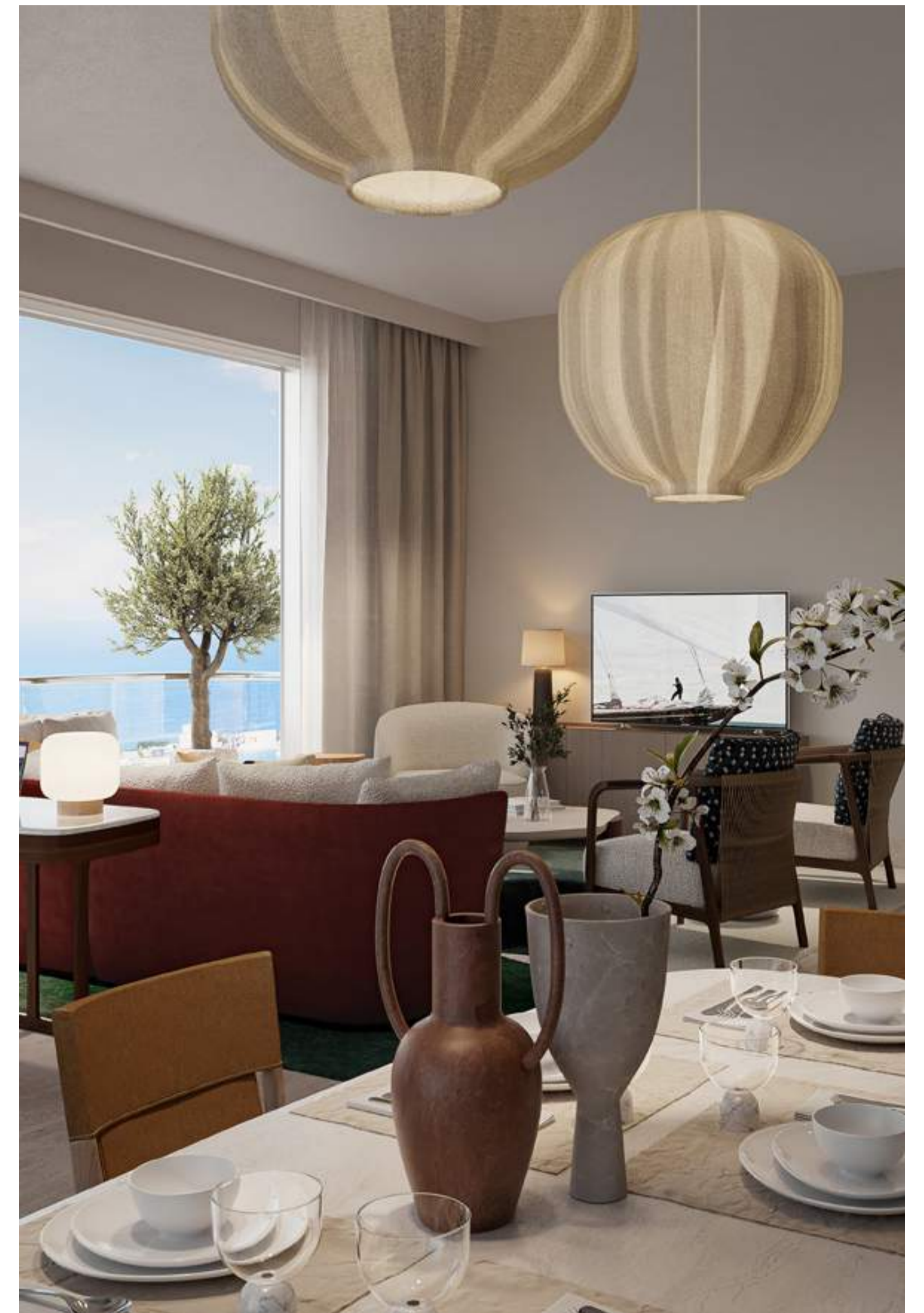





A VIBRANT ARRAY OF WORLD-CLASS AMENITIES

Shop, dine, play, and relax, with the perfect blend of world-class amenities at your doorstep. Whether your idea of beachside bliss is leisure and recreation or rest and relaxation – you'll find everything you need to fulfil your dream lifestyle.



Beach Pool
& Kids' Pools



Kids' Play
Area



Fully Equipped
Gym



Barbecue
Area



Community
Park



Gourmet Dining
Options

EMBRACE A BEACH RESORT LIFESTYLE





SUN-SOAKED PROMENADE

Explore an eclectic selection of dining, retail and leisure experiences along Emaar Beachfront's picturesque promenade.



YOUR OWN PRIVATE BEACH

Soak in the sun, take a dip or build sandcastles with your kids amidst the pristine sands of the 1.5 km long stretch of private beach.

